

CUSTOMER PART No.

CUSTOMER

CAN ART STD.

DIE No.

EH05633

DESCRIPTION

1.750" O.D. x .083" WALL ROUND TUBE

PROPOSAL No.

H-8792

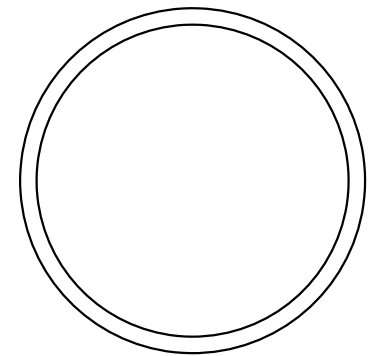
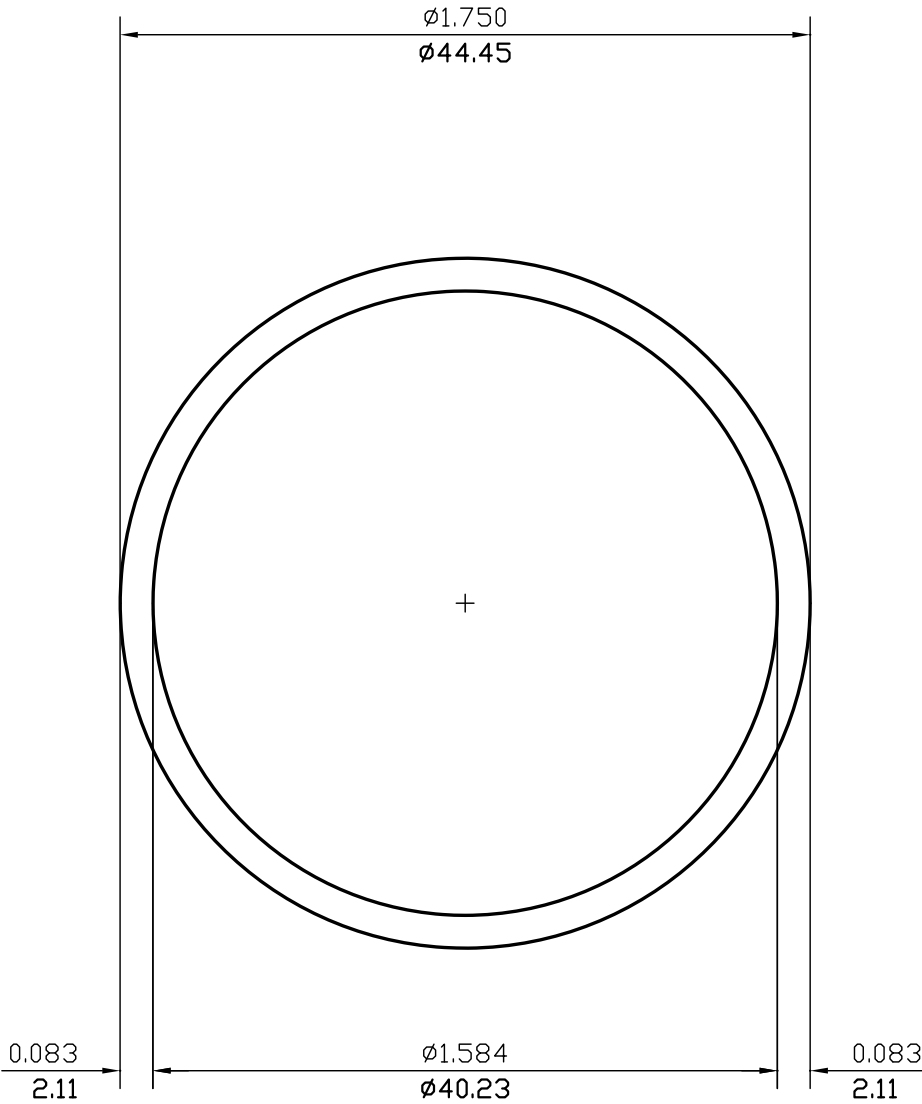

ACTUAL SIZE

NOTE: BREAK ALL CORNERS WITH 0.015" (.38 MM) RADIUS UNLESS OTHERWISE NOTED. STANDARD TOLERANCES TO APPLY UNLESS OTHERWISE SPECIFIED.

WALL THICKNESS **0.083 (2.11)** EXCEPT AS SHOWN

DATE	REV	DESCRIPTION	BY
03/10/23	2	REMOVED ALLOY	JASON
09/26/00	1	UPDATED DRAWING	P.M.
EST.AREA	0.435	IN. ²	EST.AREA 280.436
			MM. ²
EST.WT.	0.522	LBS/FT.	EST.WT. 0.776
			KG/M.
EST.PER.	10.474	IN.	EST.PER. 266.041
			MM.
OUT PER.	5.498	IN.	OUT PER. 139.6
			MM.
C.C.D.	1.750	IN.	C.C.D. 44.450
			MM.
FACTOR	20	FINISH M/F	ALLOY & TEMP.
CKD BY	SCALE 2:1	DWN BY P.M.	DATE 06/04/99

CAN ART

ALUMINUM EXTRUSION INC.

85 PARKSHORE DRIVE
BRAMPTON, ONT L6T 5M1
TEL. NO. (905) 791-1464
FAX NO. (905) 791-9151
E-MAIL: canart@canart.com

THIS DRAWING IS NOT NECESSARILY A COPY OF YOUR ORIGINAL. PLEASE APPROVE DIMENSIONS AND TOLERANCES INDICATED. CAN ART ASSUMES NO RESPONSIBILITY EITHER TECHNICAL OR LEGAL FOR HAVING THIS SHAPE MADE. THE CUSTOMER AGREES TO FULLY PROTECT CAN ART ALUMINUM FROM CLAIMS OF OTHERS RESULTING FROM THIS SHAPE.

SIGNED: _____ DATE: _____